



MEMORY CARE FLOOR PLANS

With a “residents first” philosophy, the Memory Care team embraces a proactive approach to the health and wellness of each resident, making Sodalis Buda distinctly able to provide the highest levels of care, delivered with the warmth and hospitality of a family member. The team has specialized training in memory care and programs to optimize quality of life through everyday activities in a meaningful way.

For caregivers needing extra help during the day or a caring environment to take a break or vacation, Sodalis Buda offers respite stays if rooms are available.

Each private suite includes a bathroom and A/C unit. Rates include three home-cooked meals, housekeeping, laundry, linens, utilities, activities, basic assistance with activities of daily living, and the availability of our trained care associates 24 hours a day.

PRIVATE

All inclusive rate starts at \$4,900* / month
Approximately 260 square feet

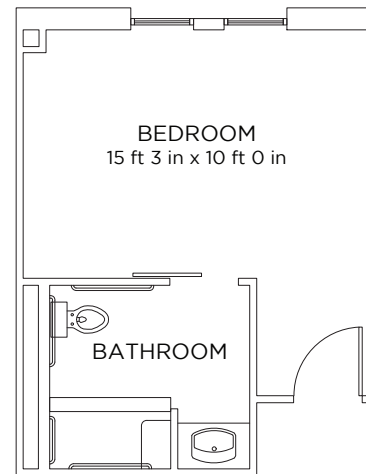

ADDITIONAL FEES:

- Level 1: Private one bedroom \$4,900 per month
- Respite Care: \$185 / \$225 night rate
Administrative Fee* (Non-Refundable) \$2,000
- Incontinence & Personal Care Program: \$350 per month
- Memory Care Plus: \$500 per month

* Administrative Fee: This is one-time charge to cover the costs associated with the Pre-Admission Assessment Process, consultation with the primary physician, pharmacy arrangements, admission assessment and service plan, preparation of the necessary medical, and financial records, and any room preparation that may be required.

Rates subject to change.